



BEYOND SECURITY

KABA[®]

Swing Doors
Personal Guiding Bars
Card Reader Posts

Adaptable design

«The use of suitably-designed swing doors, personal guiding bars and card reader posts allows us to provide barrier-free access to our customers while at the same time ensuring a smooth process with automatic release.»





The automatic Charon swing doors offer a barrier-free solution.

Benefits of swing doors, personal guiding bars and card reader posts

An ideal addition for every entry system

Swing Doors, HSD

- > Adaptable design
- > Delicate transparent elements in stainless steel and glass
- > Ideal addition for tripod barriers, half-height turnstiles, sensor barriers and for goods transportation and barrier-free access
- > Comfortable passage with servo drive
- > Quiet, noiseless operation
- > Unit also opens under load
- > Unit locks in any position
- > Separation of drive and locking forces
- > Low energy consumption
- > Suitable for use in emergency and escape routes
- > Simple assembly on finished floor level

Personal Guiding Bars, PGB

- > With or without glass panel
- > Simple assembly on finished floor level
- > Suitable for outdoor installation

Card Reader Posts, CRP

- > Prepared for customer installation of a Legic® LA-PP antenna and Kaba DML 2 control unit
- > Adaptation to different reader systems possible
- > Presence detection for unreadable cards
- > Simple assembly on finished floor level
- > Weather protective hood for outdoor installation

Swing Doors

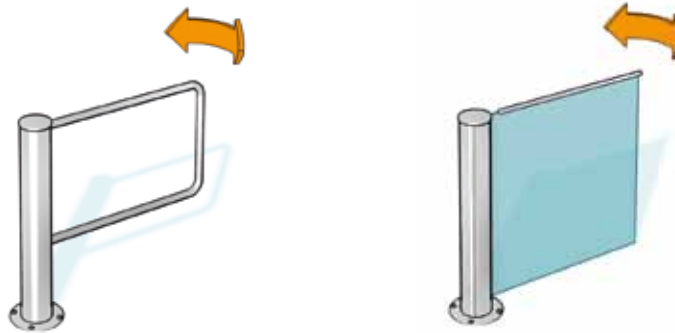

Standard units	HSD-E01	HSD-E03
Construction	Tubular column Barrier element	In stainless steel AISI 304, Ø 140. U-shaped, Ø 40 in tubular stainless steel AISI 304.
	Leaf radius	900
	Leaf upper edge	900
Finish	Locking, drive and toothed holding brake installed in tubular column. Stainless steel semi-gloss smooth finish.	Locking, drive and toothed holding brake installed in tubular column. Stainless steel semi-gloss smooth finish.
Function	Type 2* 90° opening in entrance and exit directions.	Type 2* 90° opening in entrance and exit directions.
Electrical system	Control unit and power supply unit in an external switch cabinet H = 283 / W = 168 / D = 115. Power supply 110-230 V AC, 50/60 Hz.	Control unit and power supply unit in an external switch cabinet H = 283 / W = 168 / D = 115. Power supply 110-230 V AC, 50/60 Hz.
Installation	Dowelled on finished floor level, FFL. Suitable for outdoor installation!	Dowelled on finished floor level, FFL. Not suitable for outdoor installation!

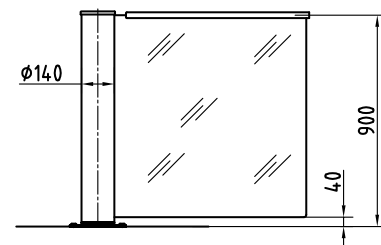
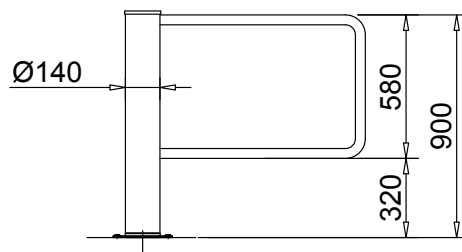

* Type 2: Power-assisted motion, servo positioning drive/ electrically controlled in 2 directions

All measurements in mm

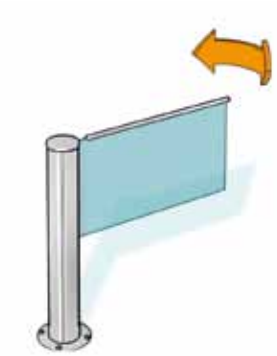

Option

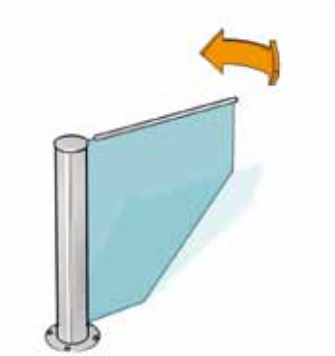

Option

HSD-EO3 with
"half-height glass element" option

HSD-EO3 with
"glass element, slanted" option

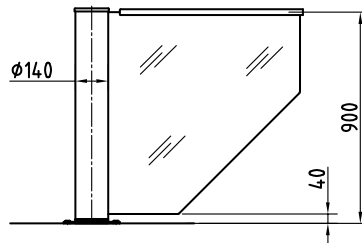
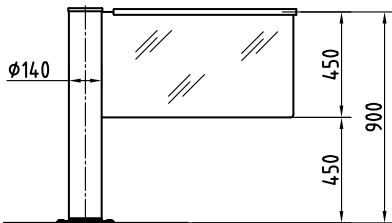

Swing Doors



Standard unit	HSD-E06
Construction Tubular column	In stainless steel AISI 304, Ø 140.
Barrier element	Full-height glass element, 10 mm TSG with straight handle bar.
Leaf radius	900
Leaf upper edge	1800
	Locking, drive and toothed holding brake installed in tubular column.
Finish	Stainless steel semi-gloss smooth finish.
Function	Type 2*
	90° opening in entrance and exit directions.
Electrical system	Control unit and power supply unit in an external switch cabinet H = 283 / W = 168 / D = 115.
	Power supply 110-230 V AC, 50/60 Hz.
Installation	Dowelled on finished floor level, FFL.
	Not suitable for outdoor installation!

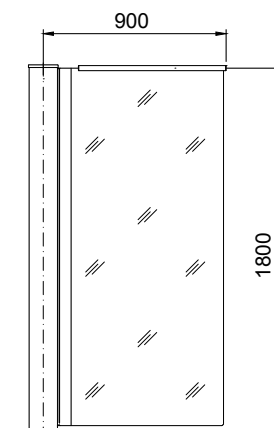

* Type 2: Power-assisted motion, servo positioning drive/ electrically controlled in 2 directions

All measurements in mm

Options (dependent on unit type)

HSD types

Construction

	HSD-E01	HSD-E03	HSD-E06
Glass element, slanted.		•	
Glass element, half-height.		•	
Passage width 1000 mm.	•	•	•
Passage width: minimum 650 mm, max. 1200 mm, max. 999 mm for HSD-E03.	•	•	
Passage width: For height 1600 mm, leaf radius max. 1100 mm; for height 1400 mm max. 1200 mm.			•
Door leaf panel in TSG (sealed at the top and bottom).	•		
Special height: Door leaf raised to max. 1200 mm, 1400 mm or 1600 mm on HSD-E06.	•	•	•
Function			
Master for linking two units as a double swing door.	•	•	•
Emergency and escape route module.	•	•	•
Additional emergency button including symbol for connection to the emergency and escape route module.	•	•	•
Electrical system			
Power supply plug 24 V DC/1A for supplying external nodes.	•	•	•
Operating panels and frame or surface mount housing.	•	•	•
Additional circuit boards for expanding existing inputs and outputs.	•	•	•
Distribution board (connection of max. 4 OPL05 possible).	•	•	•
Installation			
Mounting plate with variable substructure, measure X = 80 - 180 mm.	•	•	•
Cast-in with floor element.	•	•	•

Installation variants for swing doors

Dowelled on finished floor level (standard)

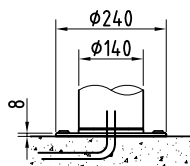

With mounting plate on sub floor level

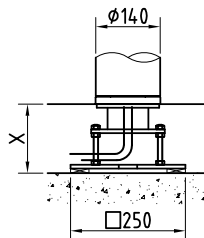

Cast-in in finished floor level

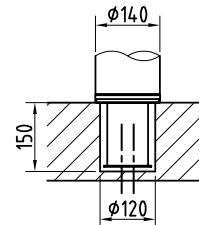

All measurements in mm

Personal Guiding Bars



Standard units	PGB-E01	PGB-E02
Construction Description	Personal guiding bars in tubular stainless steel AISI 304 semi-gloss, Ø 40 mm.	Personal guiding bars with guiding rail, height 320 mm in tubular stainless steel AISI 304, semi-gloss, Ø 40 mm.
Total height	900	900
Dimension between axes	870	870
Finish	Stainless steel semi-gloss smooth finish.	Stainless steel semi-gloss smooth finish.
Installation	Dowelled on finished floor level, FFL.	Dowelled on finished floor level, FFL.
	Suitable for outdoor installation!	Suitable for outdoor installation!

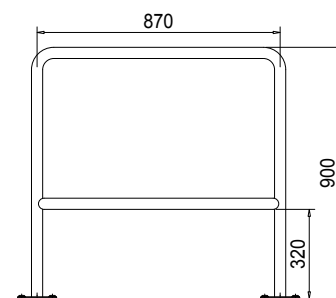
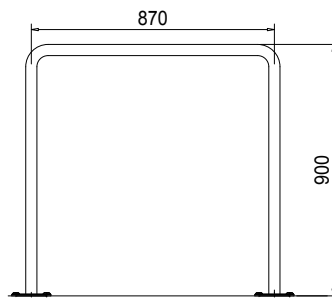

All measurements in mm

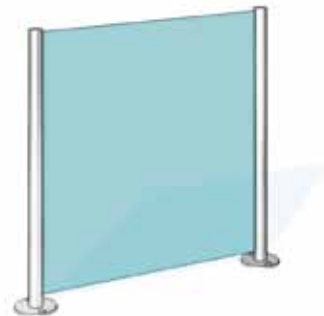
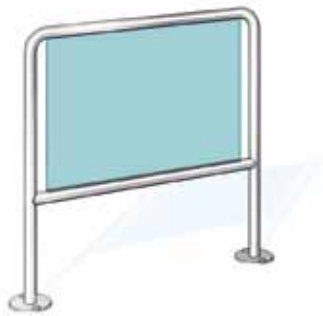

PGB-E03

Personal guiding bars with guiding rail, height 320 mm in tubular stainless steel AISI 304, semi-gloss, Ø 40 mm and TSG glass panel 6 mm.

900

870

Stainless steel semi-gloss smooth finish.

Dowelled on finished floor level, FFL.

Suitable for outdoor installation!

PGB-S01

Personal guiding bars as variable full glass barrier system with two tubular stainless steel end posts AISI 304, semi-gloss, Ø 48 mm and TSG glass panel 10 mm (visible edges ground and polished).

900

870

Stainless steel semi-gloss smooth finish.

Dowelled on finished floor level, FFL.

Suitable for outdoor installation!

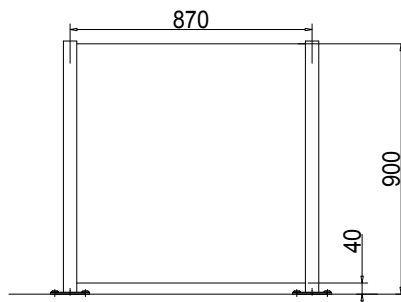
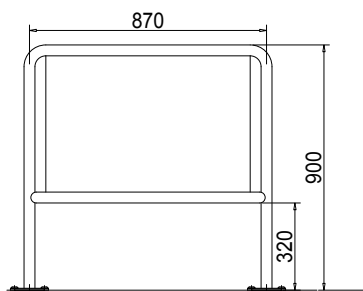

Card Reader Posts



Standard units

Construction	Description	CRP-E01
		Card reader post made of tubular stainless steel AISI 304 with aluminium spacer 80 x 35 mm coated in RAL 9006 and with cable bore for customer's reader plate (surface-mounted).
	Height	1100
	Width	-
	Depth	-
	Diameter	48 optional 60.
Finish		Stainless steel semi-gloss smooth finish.
Application		Designed for small card reader (installation provided by the customer).
Electrical system		-
Installation		On finished floor level, FFL. Suitable for outdoor installation!

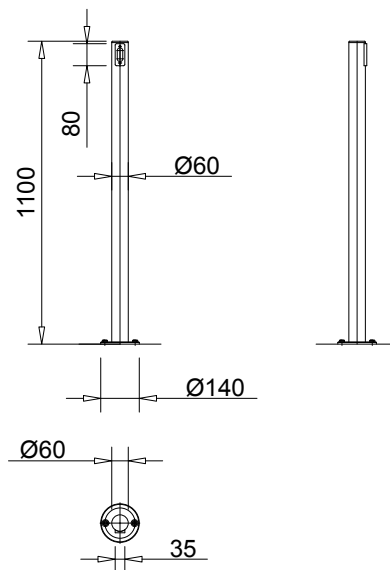

All measurements in mm



CRP-E03

Supporting column in stainless steel AISI 304 with removable inspection opening for installation of components provided by the customer (max. installation dimensions H = 170/W = 140/D = 150).

1250 optional 1550.

205

160

-

Stainless steel semi-gloss smooth finish.

Suitable for different reader formats or multiple different device installations.

-

On finished floor level, FFL.

Suitable for outdoor installation!

CRP-C01

Card reader post in tubular stainless steel AISI 304 with bevelled head (30°).

Device installations must be checked on an individual basis.

1100

-

-

206 optional 140.

Stainless steel semi-gloss smooth finish.

Attractively designed high-quality variants suitable for small card readers and signal devices.

-

On finished floor level, FFL.

Suitable for outdoor installation!

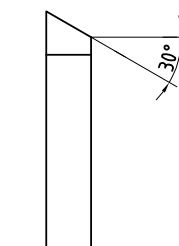
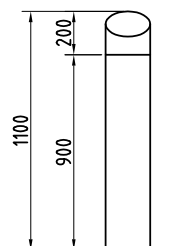
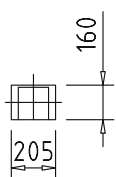
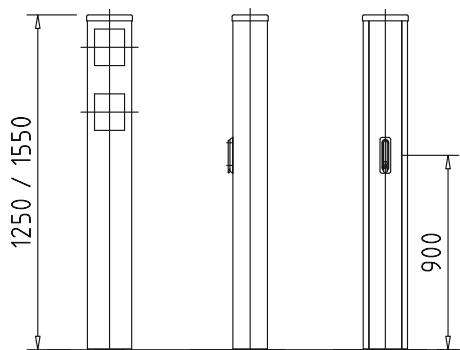

Card Reader Posts



Standard units

CRP-M01

Construction	Description
	<p>Card reader posts in tubular stainless steel AISI 304 for verifying and collecting identification, together with protective cover and clip holder (length 90 mm/width 63 mm/depth 5 mm).</p> <p>Integrated card-return tray, signal unit (red/green) in the horizontal cover, card-insert slot plus slot lock and lockable cassette.</p> <p>Presence detection for unreadable cards.</p>
	Height
	Width
	Depth
	Diameter
Finish	Stainless steel semi-gloss smooth finish.
Application	Prepared for customer installation of a Legic® LA-PP antenna and Kaba DML 2 control unit. Adaptation to other reader systems on request.
Electrical system	Power supply 24 V DC.
Installation	On finished floor level, FFL.
Note	Not suitable for outdoor installation!

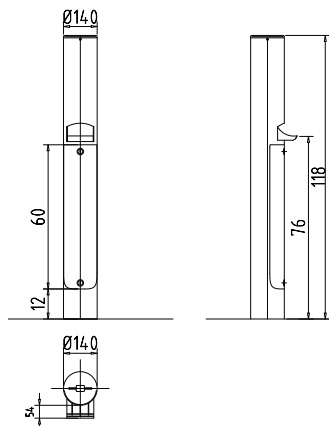

All measurements in mm



CRP-M02

Card reader posts in stainless steel AISI 304 for verifying and collecting identification, together with protective cover and clip holder (length 90 mm/width 63 mm/depth 5 mm).
 With weather protective hood for outdoor installation.
 Integrated card-return tray, signal device (red/green) in the inclined cover, card-insert slot plus slot lock and lockable cassette.
 Presence detection for unreadable cards.

1094
 260
 160
 -

Stainless steel semi-gloss smooth finish.
 Prepared for customer installation of a Legic® LA-PP antenna and Kaba DML 2 control unit.
 Adaptation to other reader systems on request.
 Power supply 110-230 V AC, 50/60 Hz.
 On finished floor level, FFL.
 Suitable for outdoor installation!

When installed outdoors, RFID cards must be used with a protective cover.

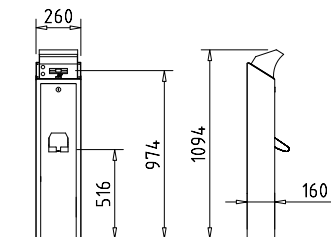

CRP-M03

Card reader posts in stainless steel AISI 304 for verifying and collecting identification, together with protective cover and clip holder (length 90 mm/width 63 mm/depth 5 mm).
 Integrated card-return tray, flat signal device (red/green) in the inclined cover and lockable cassette.
 Presence detection for unreadable cards.

2550
 350
 250
 -

Stainless steel semi-gloss smooth finish.
 Prepared for customer installation of a Legic® LA-PP antenna and Kaba DML 2 control unit.
 Adaptation to other reader systems on request.
 Power supply 110-230 V AC, 50/60 Hz.
 On finished floor level, FFL.
 Suitable for outdoor installation!

When installed outdoors, RFID cards must be used with a protective cover.

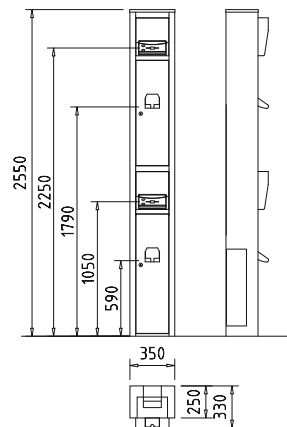

Options (dependent on unit type)

PGB types

Construction

Dimension between axes shortened (500 - 870 mm) or increased.

Mullion, for dimension between axes > 1500 mm.

	PGB-E01	PGB-E02	PGB-E03	PGB-S01
Dimension between axes shortened (500 - 870 mm) or increased.	•	•	•	•
Mullion, for dimension between axes > 1500 mm.	•	•	•	•

Installation

Mounting plate with variable substructure, measure X = 80 - 180 mm.

Mounting plate with variable substructure, measure X = 80 - 180 mm.	•	•	•	•
---	---	---	---	---

Installation variants for pedestrian guiding bars

Dowelled on finished floor level (standard)

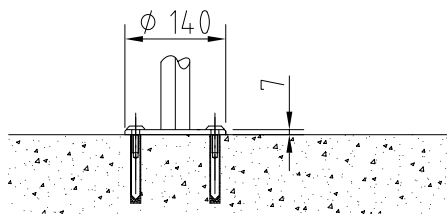

Mounting plate and variable substructure on sub floor level

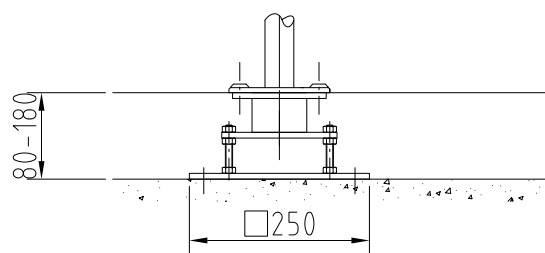

CRP types

Electrical system

Installation preparation on flat surface: right-angled cut-out for components provided by the customer.

Cover plate with flush-mounted socket for installation of components provided by the customer.

Reader console instead of aluminium spacer: Milled plate in aluminium, coated in RAL 9006, measurements adjusted to components provided by the customer.

Legic® LA-PP antenna and Kaba DML 2 control unit: installation of components provided by the customer or previously installed.

	CRP-E01	CRP-E03	CRP-C01	CRP-M01	CRP-M02	CRP-M03
Installation preparation on flat surface: right-angled cut-out for components provided by the customer.	•	•	•			
Cover plate with flush-mounted socket for installation of components provided by the customer.			•			
Reader console instead of aluminium spacer: Milled plate in aluminium, coated in RAL 9006, measurements adjusted to components provided by the customer.	•					
Legic® LA-PP antenna and Kaba DML 2 control unit: installation of components provided by the customer or previously installed.				•	•	•

Installation

Mounting plate with variable substructure, measure X = 80 - 180 mm.

Mounting plate with variable substructure, measure X = 80 - 180 mm.	•	•	•	•	•	•
---	---	---	---	---	---	---

Reader post installation variants

Mounting plate

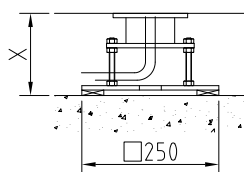

All measurements in mm



BEYOND SECURITY